



ASPIRE

— TO MOVE —



Bladud Buildings, Bath, BA1

Video and physical viewings available. One bedroom flat located in central Bath. The flat is located on the second floor and is offer unfurnished. Available July 2026

Bladud buildings is located to the north of Bath city centre and provides excellent access to local amenities on George Street, 0.1 miles away. There is a bus stop 0.2 miles away on Milsom Street.

£1,375 PCM

Bladud Buildings, Bath, BA1

- Video viewing available
- One bedroom flat
- Offered unfurnished
- Lovely views to rear
- Available July 2026
- Council tax band B
- 12 month initial tenancy
- Holding deposit: £317.00
- City central location

Video and physical viewings available. One bedroom flat located in central Bath. The flat is located on the second floor and is offer unfurnished. Available July 2026.

Bladud buildings is located to the north of Bath city centre and provides excellent access to local amenities on George Street, 0.1 miles away. There is a bus stop 0.2 miles away on Milsom Street.

The living accommodation comprises of entrance hallway with intercom, large bedroom to the front with two integrated wardrobes and sash windows with working shutters. The living room is a good size and enjoys views to the rear, there are also two cupboards providing storage. The new kitchen has base and wall units, oven, induction hob, integrated slimline dishwasher and fridge with freezer box. The gas boiler is also located in the kitchen. The shower room has shower cubicle, WC with vanity unit and toilet. In the entrance hallway is a storage cupboard which houses a washer/dryer.

The flat is available now and offer unfurnished. The flat would best suit a single professional or couple.

Council tax band B: £1,808.54 annually

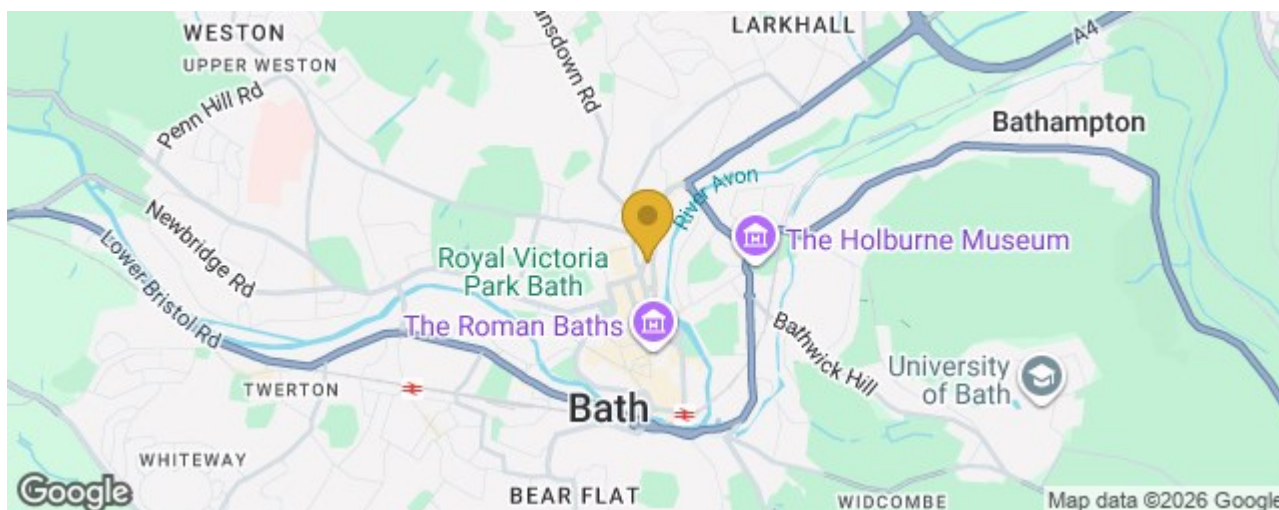



SECOND FLOOR
518 sq.ft. (48.1 sq.m.) approx.

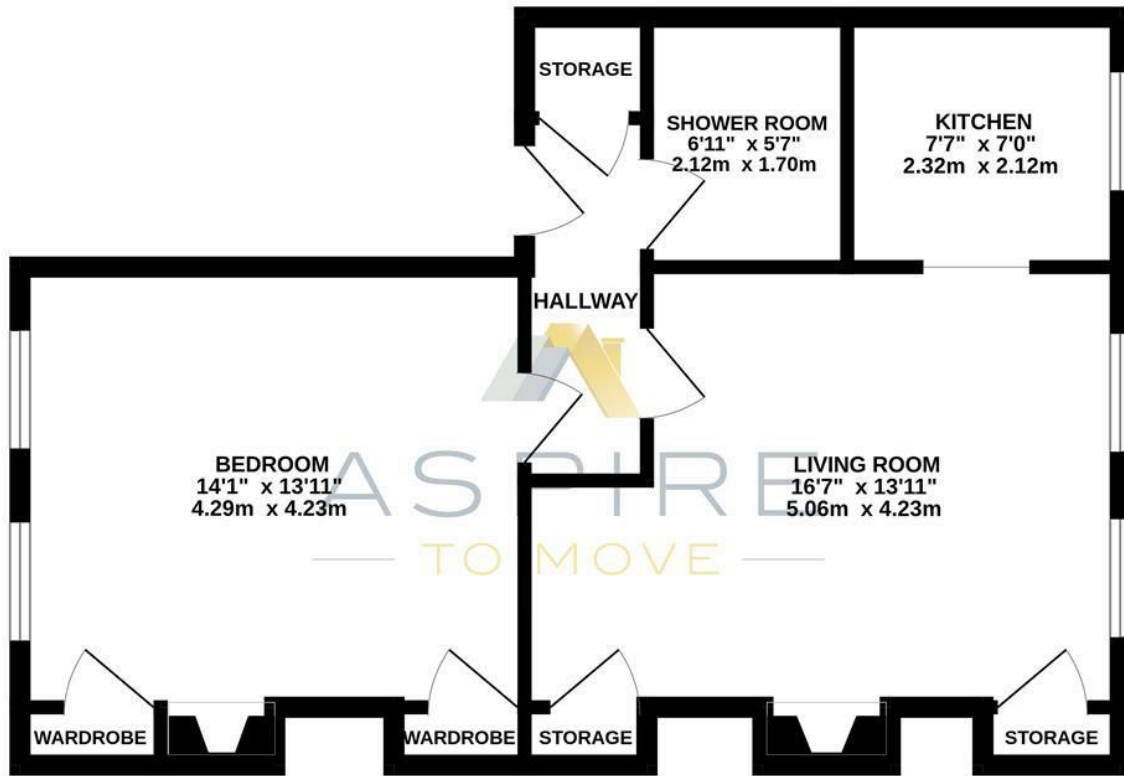

BLADUD BUILDINGS, BATH, BA1

TOTAL FLOOR AREA: 518 sq.ft. (48.1 sq.m.) approx.

Whilst every attempt has been made to ensure the accuracy of the floorplan contained here, measurements of doors, windows, rooms and any other items are approximate and no responsibility is taken for any error, omission or mis-statement. This plan is for illustrative purposes only and should be used as such by any prospective purchaser. The services, systems and appliances shown have not been tested and no guarantee as to their operability or efficiency can be given.
Made with Metropix 52024

These particulars, whilst believed to be accurate are set out as a general outline only for guidance and do not constitute any part of an offer or contract. Intending purchasers should not rely on them as statements of representation of fact, but must satisfy themselves by inspection or otherwise as to their accuracy. No person in this firm's employment has the authority to make or give any representation or warranty in respect of the property.

